



The Professional's
Choice for
Radiographic Imaging

InnoVet™

Leading the Profession

InnoVet, the most respected name in veterinary radiography, leads the profession in product performance, reliability and support. With products that are designed by veterinarians for veterinarians, InnoVet has the radiographic system that will best fit the needs of your practice.

The InnoVet product line is designed for you by Summit Industries, a Chicago-based manufacturer of radiographic equipment celebrating over 20 years of creating innovative radiography products for clinical applications. In all, Summit has manufactured over 20,000 veterinarian and human medical systems, which currently produce over 50 million quality images annually.

As the leader in the veterinary industry, Summit has happily donated InnoVet systems to nearly every vet school in the U.S. Since 1995, 80% of all DVM undergraduates were trained on an InnoVet.

The InnoVet Family

At Summit, we recognize that all practices are not the same. Some are limited in space, others are spacious. Some take 5 films a day, others take 100. Some specialize in exotics, others in large animals. Some are new openings, others are long-time practices. But not to worry, there is an InnoVet model to fit every practice need.

InnoVet Classic

Ideal for the budget-minded and/or floor space restricted facility.

Since 1995, the InnoVet Classic has been the #1 selling veterinarian x-ray machine in the U.S.

Over 3,000 InnoVet Classic's currently satisfy the general radiographic needs of budget minded or space-restricted practices.

The Classic features a full-size table top, a tilt-out control, and a 300 mA / 125 kVp generator all packaged in the industry's smallest floor space requirement of 28" x 53".



InnoVet Select

Customize this InnoVet to your exact radiographic and budgetary needs.

The InnoVet Select is a special version of the Classic which allows for customization by the end user. By selecting from over 15 options, you may tailor the system to meet your specific needs and at the same time avoid paying for unwanted features. In recent years, the average InnoVet Select featured 5.3 options and sold for a price \$2,900 less than a fully-loaded system.

Examples of popular InnoVet Select options include:

- A 300 mA high frequency generator that is 30% more powerful than standard frequency.
- An upgrade of the 300 mA high frequency generator to an even more powerful 500mA.
- A 2-way or 4-way float top table
- One or two easy – access cassette bins.
- The “no-hands” collimator system.
- An anatomically programmed console.

Whichever options you may choose, you are sure to find them to be valuable, easy to use additions to your InnoVet Select.

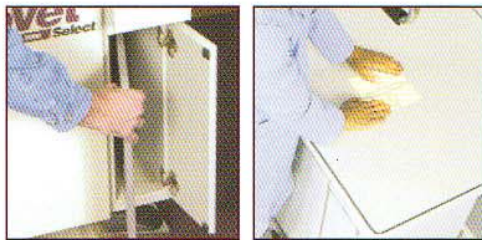

InnoVet Specialist

The InnoVet Specialist system recognizes the variety of needs that large busy practices or a specialty practice might have. By utilizing Summit's vast line of human medical systems, any possible need can be satisfied including:

- Tables with large 30" x 76" floating tops.
- Tables that can support a 650 lb. animal.
- Tables that can be raised and lowered by an electric motor.
- Tubestands that have several axis of motion for that difficult orthopedic procedure.
- Tubestands that ceiling mount to free more floor space.
- Generators that deliver 100% more penetrating power.

Whatever your need, Summit can configure a high-quality Specialist system to fit.



Experienced Dealer Support is Standard

With over 6,000 happy veterinary customers, our typical authorized InnoVet dealer has installed over 100 systems and uses that experience to ensure each future system will be installed and maintained to the highest factory standards. Our dealers stock parts and are factory trained to keep your system running like new, with little or no downtime. No other manufacturer can claim the same high-quality product and skilled local service. Your satisfaction is our highest priority.

Built-in Quality Protects Your Investment



From the professional engineering design through the rigorous manufacturing process, adherence to the highest level quality assurance measures guarantees that every InnoVet will provide years of trouble-free operation. Summit's ISO 9001 certification recognizes our commitment to quality.

And as a testimonial to our commitment to quality, Summit proudly backs every InnoVet with a 7-year, defective parts warranty, the best warranty in the industry.



Digital Ready - Right for Today or Tomorrow

InnoVet radiographic systems are compatible with most digital imaging systems. Our InnoVet DVM - Digital Veterinary Module, can be easily added to an InnoVet at time of purchase or any time after purchase to convert your system to a DICOM-compliant digital imaging system. Or, for the ultimate in digital imaging, ask about our top of the line InnoVet DXR.



Features and options of the InnoVet family

	InnoVet Classic	InnoVet Select	InnoVet Specialist
Generator			
Tilt-out control panel	✓	✓	
Standard Frequency, 300 mA, 125 KV	✓	✓	
Additional 30 or 400 mA capability		Option	
High Frequency, 300 mA, 125 KV		Option	✓
Additional 500 mA high frequency capability		Option	Option
Automatic generator "shut-off" circuit		✓	✓
High voltage transformer mounting shelf		✓	✓
Anatomical programming		Option	Option
Table			
Stationary Table Top	✓	✓	
2-way Float Table Top		Option	
Extended Length Table Top		Option	
4-way Float Table Top		Option	✓
Table top fluid trough		Option	
Animal restraining device	Option	✓	✓
Cassette storage bin with accessory drawer		Option	
Simplex non-metallic cassette tray	Option	✓	
Exposure foot treadle with latching prep circuit		Option	
Wall Mounted hand operated exposure switch	Option	Option	Option
Collimator			
Swivel mount	Option	✓	✓
"No-hands" collimator light control system		Option	
Warranty			
7-year parts warranty	✓	✓	✓
Digital Upgrade			
InnoVet DVM Digital Veterinary Module	Option	Option	Option

InnoVet™

Over 6,000 Owners

Your Partners in Radiography

2901 W. Lawrence Ave. • Chicago, IL 60625
 800-972-9776 • 773-588-2444 • Fax 773-588-3424
 www.innovet4vets.com